

# AMG570-8G-3S-K SERIES 11 PORT INDUSTRIAL GRADE MANAGED LAYER 2+ SWITCHES WITH PSU & SFP KITS



## Industrial Ethernet Solutions

AMG's fully managed layer 2+ Ethernet switch kits provide convenient single part codes that include switch, power supply, 2x SFP modules and all the necessary mounting and cable accessories in one complete package. Available with 8x RJ45 Gigabit ports supporting optional 30/60/90W PoE and 3x 100Mb/1Gb/2.5Gb SFP ports.



											[ AMG570-8GAT-3S-P240-KS1 ]
Gigabit up to x8	Gigabit up to x4	Gigabit up to x8	1/2.5 Gb x3	Managed Layer 2+	Contacts 1 In / 2 Out	Temp -40°C to +75°C	Mounting DIN/Surface	SFP 2x Included	PSU Included	NDA/TAA Compliant	

### OVERVIEW

AMG570 series layer 2+ managed industrial Ethernet switches are designed in a thermally efficient DIN rail or wall mount housing and have 8 Gigabit Ethernet RJ45 ports with an additional 3 multi-rate SFP ports that support 100Mb, 1Gb and 2.5Gb for high speed data uplink into core networks, providing application and site flexibility.

Available as a non-PoE model as well as multiple PoE models for IEEE802.3at 30W and/or IEEE802.3bt 60/90W they are suitable for powering the latest high powered PoE devices over a wide industrial operating temperature range.

The AMG570-8G-3S-K series kits provide a single part code that combines the specific AMG570 industrial Ethernet switch with its appropriate industrial power supply, two industrial SFP modules for fiber connectivity as well as a DIN rail for mounting both devices and all the necessary power cables to operate the switch. All of this comes packaged in a single purpose made box for the most convenient deployment experience.

For full individual device specifications please follow the links provided in the Kit Contents section.

### FEATURES

- Innovative thermally efficient housing ensures high levels of device reliability under full load
- -40°C to +75°C temperature maintains performance in extreme conditions
- DIN rail or wall mountable - quick to install and remove for maintenance
- Compliant with all IEEE 802.3 speeds (i/u/ab/z)
- Triple Speed SFP ports (100Mb, 1Gb, 2.5Gb)
- Supports RSTP, MSTP, ERPS, MRP, SNMP and IGMP
- IEEE 802.1x port security enabled
- Supports optional 15W, 30W, 60W and 90W PoE
- Layer 3 Static Routing
- Designed in the USA & UK. Manufactured in the United Kingdom
- AMG Lifetime support warranty on switch & SFP modules. 3 year support warranty on PSU's

# Specifications.

## Packaging.

### Shipping Weight:

AMG570-8G-3S-K Series	1.79kg / 3.95lb
AMG570-8GAT-3S-P240-K Series	2.41kg / 5.31lb
AMG570-2GBT-4GAT-2G-3S-P300-K Series	2.81kg / 6.20lb
AMG570-4GBT-4G-3S-P360-K Series	2.81kg / 6.20lb

Dimensions	(W x D x H)
	260 x 200 x 130 mm
	10.24 x 7.87 x 5.12 in

## Regulatory.

Safety	IEC/EN/UL 62368-1	
EMI	EN55032 Class A	
	FCC Part 15B Class A	
EMS	EN61000-4-2 (ESD)	EN61000-4-3 (RS)
	EN61000-4-4 (EFT)	EN61000-4-5 (Surge)
	EN61000-4-6 (CS)	EN61000-4-8 (PFMF)
Shock	IEC 60068-2-27	
Free Fall	IEC 60068-2-32	
Vibration	IEC 60068-2-6	
Environmental	Reach, RoHS, WEEE	
Traffic	NEMA TS2	
Supply Chain	NDAA & TAA Compliant	

# Part Numbers.

## Industrial Layer 2+ Managed Switch Kits With PSU & 2x SFP Modules

AMG570-8G-3S-KM1	8x 10/100/1000TX, 3x 100M/1G/2.5G SFP Switch, 12V, 24W (2A) PSU, DIN Rail, Cables, 2x 1Gb MM SFP, 500m
AMG570-8G-3S-KS1	8x 10/100/1000TX, 3x 100M/1G/2.5G SFP Switch, 12V, 24W (2A) PSU, DIN Rail, Cables, 2x 1Gb SM SFP, 20Km
AMG570-8GAT-3S-P240-KM1	8x 10/100/1000TX (8x 30W PoE), 3x 100M/1G/2.5G SFP Switch, 48V, 240W (5A) PSU, DIN Rail, Cables, 2x 1Gb MM SFP, 500m
AMG570-8GAT-3S-P240-KS1	8x 10/100/1000TX (8x 30W PoE), 3x 100M/1G/2.5G SFP Switch, 48V, 240W (5A) PSU, DIN Rail, Cables, 2x 1Gb SM SFP, 20Km
AMG570-2GBT-4GAT-2G-3S-P300-KM1	8x 10/100/1000TX (2x 90W, 4x 30W PoE & 2x Non-PoE), 3x 100M/1G/2.5G SFP Switch, 48V, 480W (10A) PSU, DIN Rail, Cables, 2x 1Gb MM SFP, 500m
AMG570-2GBT-4GAT-2G-3S-P300-KS1	8x 10/100/1000TX (2x 90W, 4x 30W PoE & 2x Non-PoE), 3x 100M/1G/2.5G SFP Switch, 48V, 480W (10A) PSU, DIN Rail, Cables, 2x 1Gb SM SFP, 20Km
AMG570-4GBT-4G-3S-P360-KM1	8x 10/100/1000TX (4x 90W PoE & 4x Non-PoE), 3x 100M/1G/2.5G SFP Switch, 48V, 480W (10A) PSU, DIN Rail, Cables, 2x 1Gb MM SFP, 500m
AMG570-4GBT-4G-3S-P360-KS1	8x 10/100/1000TX (4x 90W PoE & 4x Non-PoE), 3x 100M/1G/2.5G SFP Switch, 48V, 480W (10A) PSU, DIN Rail, Cables, 2x 1Gb SM SFP, 20Km

# Included Switch Accessories.

DIN Rail Adapter  
Wall Mounting Brackets  
USB Console Cable

Rear Mounted Metal DIN Rail Clip & Screws For DIN Rail Mounting AMG570 Series Products  
2x Wall Mounting Brackets & Screws For Wall / Surface Mounting AMG570 Series Products  
USB Type A to Type C Console Cable (1.5M)

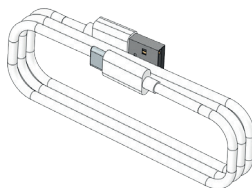
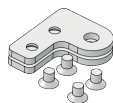
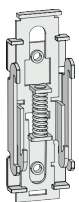

Proud to be a British  
Manufacturer 

In a continuing effort to improve and advance technology, product specifications are subject to change without notice. Please visit [www.amgsystems.com](http://www.amgsystems.com) for the latest product specifications.

AMG Systems Ltd. 4 Pioneer Way, Castleford, WF10 5QU, UK T: +44 (0) 1767 600 777 E: [sales@amgsystems.com](mailto:sales@amgsystems.com)  
AMG Systems Inc. 62 Spring Hill Road, Trumbull, CT 06611, USA T: +1-855-AMGPOE1 (855-264-7631) E: [sales@amgsystems.com](mailto:sales@amgsystems.com)  
D36306-00 [amgsystems.com](http://amgsystems.com)

**AMG**

# Kit Contents.

## AMG570-8G-3S-KM1

### Switch

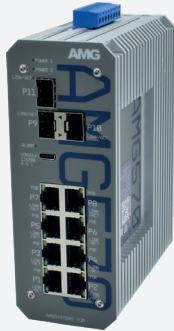

AMG570-8G-3S

8x 10/100/1000TX, 3x 100M/1G/2.5G SFP



### Power Supply



AMGPSU-I12-P24-K

Industrial DIN Rail Power Supply Kit, 12V, 24W (2A), DIN Rail, Mains & DC Cables



### SFP Modules



2x SFP-MM-1G-SX05-85

SFP Multimode, 1Gb, 2 Fibres, 500m, LC Connectors, 850nm Tx/Rx, DDM



Scan or click the QR code to view the individual kit items detailed product information

## AMG570-8G-3S-KS1

### Switch



AMG570-8G-3S

8x 10/100/1000TX, 3x 100M/1G/2.5G SFP



### Power Supply



AMGPSU-I12-P24-K

Industrial DIN Rail Power Supply Kit, 12V, 24W (2A), DIN Rail, Mains & DC Cables



### SFP Modules



2x SFP-SM-1G-LX20-31

SFP Singlemode, 1Gb, 2 Fibres, 20Km, LC Connectors, 1310nm Tx/Rx, DDM



Scan or click the QR code to view the individual kit items detailed product information

# Kit Contents.

## AMG570-8GAT-3S-P240-KM1

### Switch

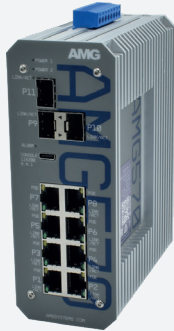

AMG570-8GAT-3S-P240

8x 10/100/1000TX (8x 30W PoE), 3x 100M/1G/2.5G SFP



### Power Supply



AMGPSU-I48-P240-K

Industrial DIN Rail Power Supply Kit, 48V, 240W (5A), DIN Rail, Mains & DC Cables



### SFP Modules



2x SFP-MM-1G-SX05-85

SFP Multimode, 1Gb, 2 Fibres, 500m, LC Connectors, 850nm Tx/Rx, DDM



Scan or click the QR code to view the individual kit items detailed product information

## AMG570-8GAT-3S-P240-KS1

### Switch



AMG570-8GAT-3S-P240

8x 10/100/1000TX (8x 30W PoE), 3x 100M/1G/2.5G SFP



### Power Supply



AMGPSU-I48-P240-K

Industrial DIN Rail Power Supply Kit, 48V, 240W (5A), DIN Rail, Mains & DC Cables



### SFP Modules



2x SFP-SM-1G-LX20-31

SFP Singlemode, 1Gb, 2 Fibres, 20Km, LC Connectors, 1310nm Tx/Rx, DDM



Scan or click the QR code to view the individual kit items detailed product information

# Kit Contents.

## AMG570-2GBT-4GAT-2G-3S-P300-KM1

### Switch

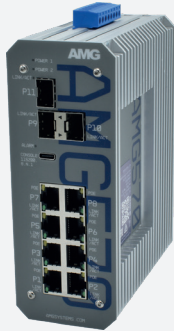

AMG570-2GBT-4GAT-2G-3S  
8x 10/100/1000TX (2x 90W, 4x 30W PoE & 2x Non-PoE), 3x 100M/1G/2.5G SFP



### Power Supply



AMGPSU-I48-P480-K  
Industrial DIN Rail Power Supply Kit, 48V, 480W (10A), DIN Rail, Mains & DC Cables



### SFP Modules



2x SFP-MM-1G-SX05-85  
SFP Multimode, 1Gb, 2 Fibres, 500m, LC Connectors, 850nm Tx/Rx, DDM



Scan or click the QR code to view the individual kit items detailed product information

## AMG570-2GBT-4GAT-2G-3S-P300-KS1

### Switch



AMG570-2GBT-4GAT-2G-3S  
8x 10/100/1000TX (2x 90W, 4x 30W PoE & 2x Non-PoE), 3x 100M/1G/2.5G SFP



### Power Supply



AMGPSU-I48-P480-K  
Industrial DIN Rail Power Supply Kit, 48V, 480W (10A), DIN Rail, Mains & DC Cables



### SFP Modules



2x SFP-SM-1G-LX20-31  
SFP Singlemode, 1Gb, 2 Fibres, 20Km, LC Connectors, 1310nm Tx/Rx, DDM



Scan or click the QR code to view the individual kit items detailed product information



# Kit Contents.

## AMG570-4GBT-4G-3S-P360-KM1

### Switch

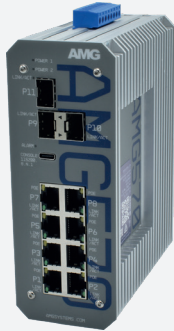

AMG570-4GBT-4G-3S-P360

8x 10/100/1000TX (4x 90W PoE & 4x Non-PoE), 3x 100M/1G/2.5G SFP



### Power Supply



AMGPSU-I48-P480-K

Industrial DIN Rail Power Supply Kit, 48V, 480W (10A), DIN Rail, Mains & DC Cables



### SFP Modules



2x SFP-MM-1G-SX05-85

SFP Multimode, 1Gb, 2 Fibres, 500m, LC Connectors, 850nm Tx/Rx, DDM



Scan or click the QR code to view the individual kit items detailed product information

## AMG570-4GBT-4G-3S-P360-KS1

### Switch



AMG570-4GBT-4G-3S-P360

8x 10/100/1000TX (4x 90W PoE & 4x Non-PoE), 3x 100M/1G/2.5G SFP



### Power Supply



AMGPSU-I48-P480-K

Industrial DIN Rail Power Supply Kit, 48V, 480W (10A), DIN Rail, Mains & DC Cables



### SFP Modules



2x SFP-SM-1G-LX20-31

SFP Singlemode, 1Gb, 2 Fibres, 20Km, LC Connectors, 1310nm Tx/Rx, DDM



Scan or click the QR code to view the individual kit items detailed product information